

ITEM	MODEL NUMBER	DESCRIPTION
1	MDR-641 VARIANTS	MDR-600 4G (OPTIONAL) & WIFI (OPTIONAL), 4 ANALOGUE CHANNELS, 1 IP CHANNEL, 500GB / 1TB / 2TB CMR / SSD
	MDR-644 VARIANTS	MDR-600 4G (OPTIONAL) & WIFI (OPTIONAL), 4 ANALOGUE CHANNELS, 4 IP CHANNELS, OPTIONAL CMR/SSD, 64GB SD
2	MDR-PWR-02	MDR POWER CABLE 9-PIN
3	MDR-PWR-01	MDR POWER CABLE
4	MDR-AC-HWU-01	MDR ADAPTER CABLE FOR HAZARD WARNING UNIT
5	MDR-HWU-01	HAZARD WARNING UNIT
6	VBV-7104HFM	SELECT MONITOR, 10.4" AHD, 4 INPUTS, AUDIO
7	IP-DFC-AI-WS-01	IP AI CAMERA-DRIVER FACING, WINDSCREEN MOUNT
8	IP-DFC-AI-AP-01	IP AI CAMERA - DRIVER FACING, A-PILLAR MOUNT
9	IP-DFC-AI-DB-01	IP AI CAMERA - DRIVER FACING, DASHBOARD MOUNT
10	IP-FFC-AI-01	IP AI CAMERA - FORWARD FACING, AUDIO (1520P)
11	IP-L6XX	IP CAMERA EXTENSION CABLE - 1M, 3M, 5M, 10M, 15M, 20M, 30M (OPTIONAL)
12	AC-075	CMS ADAPTER CABLE SELECT FEMALE TO FEMALE
13	AC-020	ADAPTER CABLE (OPTIONAL) ELITE SERIES MONITOR TO SELECT SERIES CABLE OR CAMERA

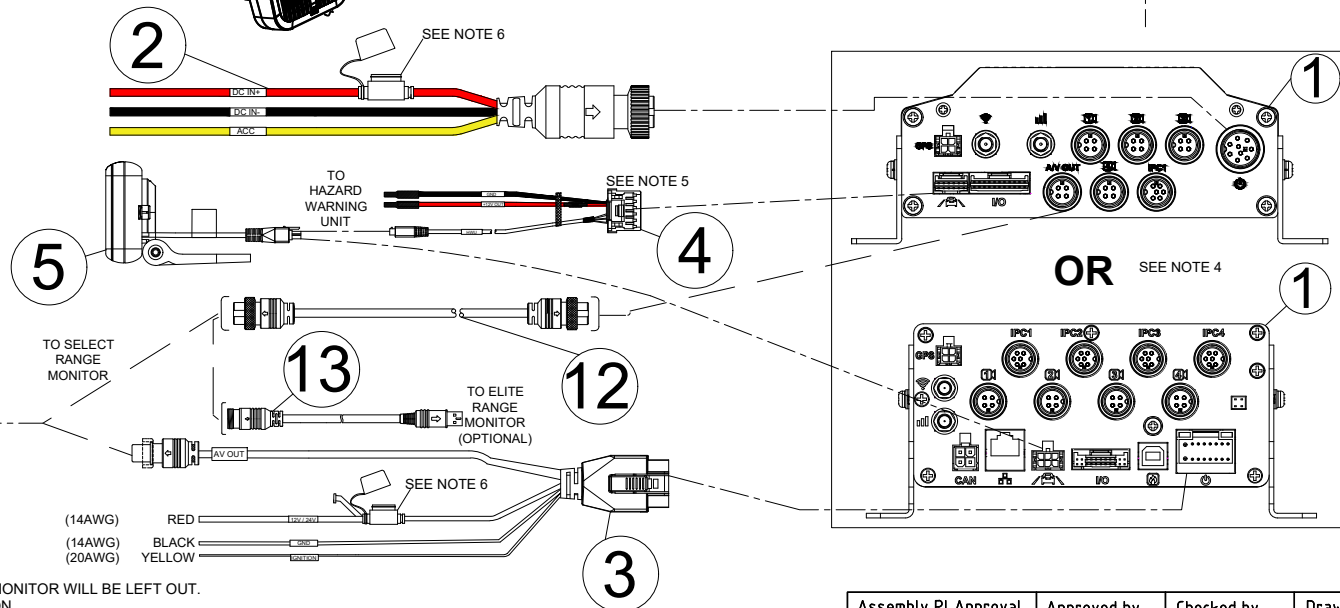
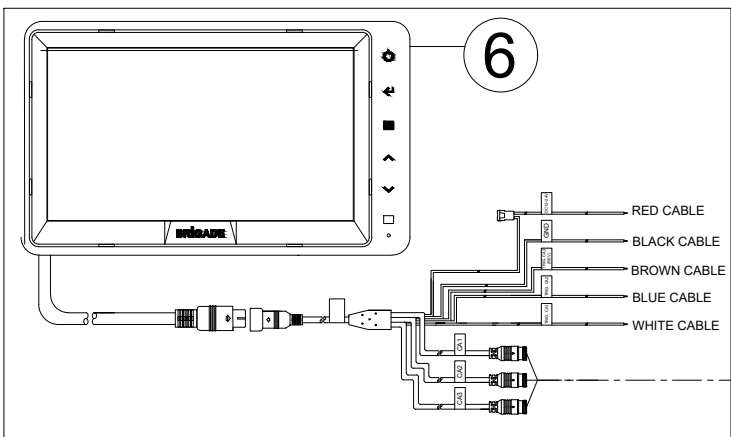
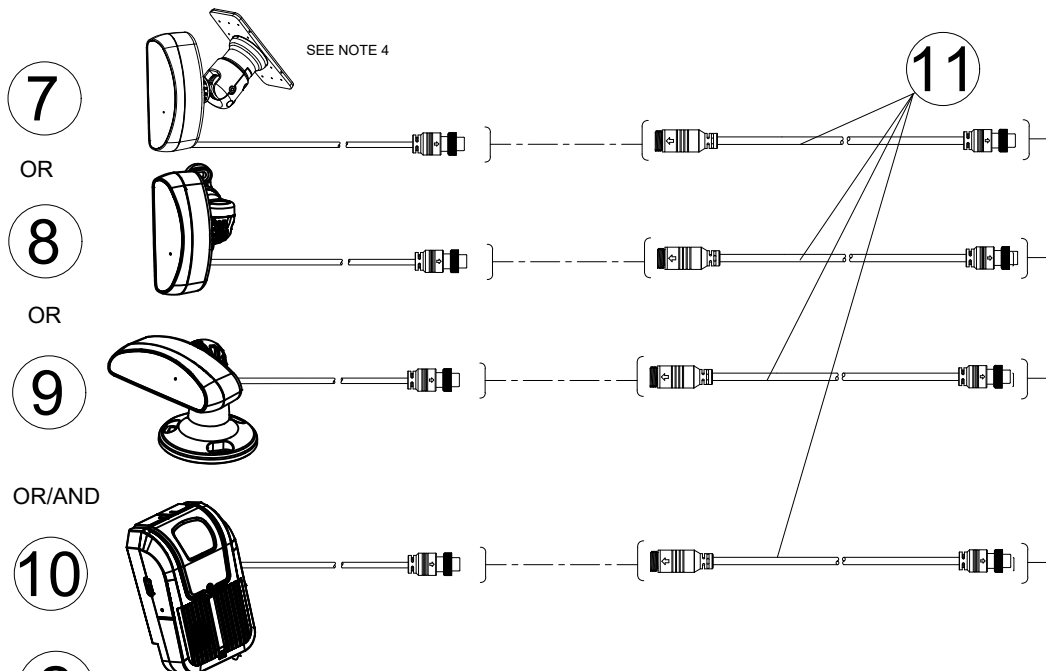

- NOTES:**
- FOR COMPONENT DETAIL, REFER TO INDIVIDUAL COMPONENT DRAWINGS.
 - THIS DIAGRAM ONLY REFLECT CONNECTION DIAGRAM FOR IP CAMERAS, OTHER PARTS SUCH AS MONITOR WILL BE LEFT OUT.
 - PLEASE REFER TO INSTALLATION GUIDE FOR CORRECT SETUP, CONFIGURATION AND INSTALLATION.
 - MDR-644 CONNECTS TO A MINIMUM OF 4 IP CAMERAS WHILE MDR-641 CONNECTS TO ONE IP CAMERA
 - ONLY REQUIRED FOR MDR 641 SERIES, MDR 644 SERIES HAS DIRECT CONNECTION TO MDR-HWU-01.
 - A 7.5 A FUSE (INCLUDED) SHOULD BE USED FOR 24V AND A 15A FUSE (INCLUDED) USED FOR 12V.
 - ANY CUSTOMER MODIFICATION OF THIS PRODUCT CAUSING SUBSEQUENT FAILURE IS NOT A LIABILITY OF BRIGADE ELECTRONICS GROUP PLC.

PROPRIETARY NOTICE
 THIS DESIGN AND TECHNICAL INFORMATION APPEARING ON THIS DRAWING IS THE PROPERTY OF BRIGADE ELECTRONICS, AND IS DISCLOSED IN CONFIDENCE. IT IS NOT TO BE COPIED, REPRODUCED, REVEALED TO OR EXPROPRIATED BY OTHERS, EITHER IN WHOLE OR IN PART WITHOUT THE EXPRESS WRITTEN CONSENT OF BRIGADE ELECTRONICS.

BRIGADE
 www.brigade-electronics.com

Assembly Pl Approval N/A	Approved by SOFIA ZHANG	Checked by FEYISIKE ADEMUJIMI	Drawn by R.TIMMS
Angle of Projection Third Angle	Units mm	Scale N/A	Released 30.9.2024
Status RELEASED	Part No N/A	Assembly Ref N/A	
		IP AI CAMERAS GENERIC	
		BE-004976-00-24	